

Elevator MAX technical data sheet

1. DESCRIPTION

Modular formwork for lightweight structural fillings up to 300cm height



2. TECHNICAL SPECIFICATION

| | | |
|------------------------------------|----|--|
| Formwork, foot and spacer material | - | Recycled polypropylene 100% Type GRAPLENE |
| Pipe material | - | PVC |
| Formwork dimension* | cm | 71 x 71 x H15 |
| Foot dimension | mm | Ø int 125 - 160 - 200 |
| Spacer dimension | cm | 50 x 7 |
| Weight formwork / foot / spacer | kg | 3,0 (± 10%) / 0,13 / 0,13 |
| Place of production | - | Italy |

* in consideration of the recycled material, the measures should be evaluated with a tolerance of ± 1,5%

| | Ø Pipe | Formula*** |
|--|--------|------------------------|
| Concrete consumption flush to the formwork** (m ³ /m ²) | 125 | [0,025x(h-0,15)]+0,036 |
| | 160 | [0,040x(h-0,15)]+0,036 |
| | 200 | [0,063x(h-0,15)]+0,036 |

** The volume is subject to changes depending on the pouring conditions and material tolerances

*** Where "h" is the height of formwork expressed in m.

3. TECHNICAL DRAWINGS

Formwork

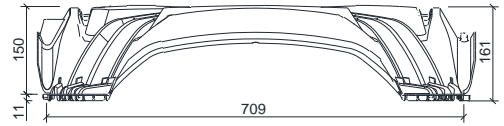
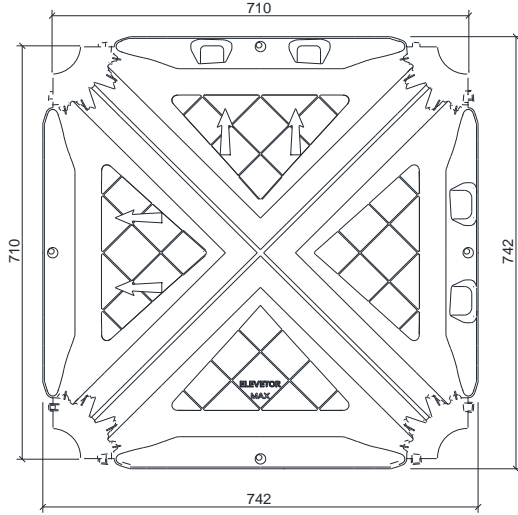

Foot

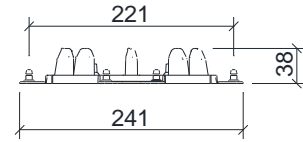
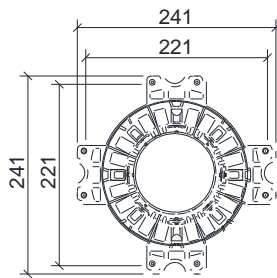

Spacer

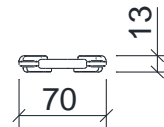
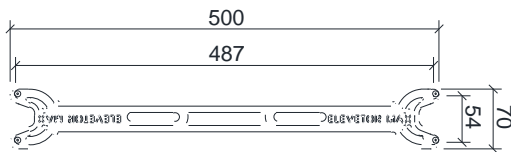

4. LOAD CHART

Pipe Ø 125 cm

| LOAD CLASS | Distributed load (kg/m ²) | Upper slab thk. (cm) | Reinforcement * | Pipe Reinforcement * | Slab on grade thk. (cm) | Subgrade thk. (cm) | Pressure on soil (ULS) (kg/cm ²)** |
|---------------------------------|---------------------------------------|---|-----------------|----------------------|-------------------------|--------------------|--|
| Residential [Cat. A] | 0 - 500 | 5 | Ø6 / 20x20 | 4 Ø6 | 5 | - | 1,60 |
| Crowd places [Cat. B e C] | 500 - 1.000 | 6 | Ø6 / 15x15 | 4 Ø6 | 5-7 | 0-5 | 1,42 |
| Commercial [Cat. D] | 1.000 - 2.500 | 6-8 | Ø8 / 15x15 | 4 Ø6 | 7-10 | 5-15 | 1,45 |
| Industrial and storage [Cat. E] | 2.500 - 5.000 | 8-12 | Ø10 / 20x20 | 4 Ø8 | 10-15 | 15-20 | 1,71 |
| > 5.000 kg/m ² | > 5.000 | To be evaluated contacting Geoplast's technical dept. | | | | | |

Pipe Ø 160 cm

| LOAD CLASS | Distributed load (kg/m ²) | Upper slab thk. (cm) | Reinforcement * | Pipe Reinforcement * | Slab on grade thk. (cm) | Subgrade thk. (cm) | Pressure on soil (ULS) (kg/cm ²)** |
|---------------------------------|---------------------------------------|---|-----------------|----------------------|-------------------------|--------------------|--|
| Residential [Cat. A] | 0 - 500 | 5 | Ø6 / 20x20 | 4 Ø6 | 5 | - | 1,18 |
| Crowd places [Cat. B e C] | 500 - 1.000 | 6 | Ø6 / 15x15 | 4 Ø6 | 5-7 | - | 1,42 |
| Commercial [Cat. D] | 1.000 - 2.500 | 6-8 | Ø8 / 15x15 | 4 Ø6 | 7-10 | 5-10 | 1,59 |
| Industrial and storage [Cat. E] | 2.500 - 5.000 | 8-12 | Ø10 / 20x20 | 4 Ø8 | 8-12 | 10-15 | 1,84 |
| > 5.000 kg/m ² | > 5.000 | To be evaluated contacting Geoplast's technical dept. | | | | | |

Pipe Ø 200 cm

| LOAD CLASS | Distributed load (kg/m ²) | Upper slab thk. (cm) | Reinforcement * | Pipe Reinforcement * | Slab on grade thk. (cm) | Subgrade thk. (cm) | Pressure on soil (ULS) (kg/cm ²)** |
|---------------------------------|---------------------------------------|---|-----------------|----------------------|-------------------------|--------------------|--|
| Residential [Cat. A] | 0 - 500 | 5 | Ø6 / 20x20 | 4 Ø6 | 5 | - | 0,89 |
| Crowd places [Cat. B e C] | 500 - 1.000 | 6 | Ø6 / 15x15 | 4 Ø6 | 5 | - | 1,42 |
| Commercial [Cat. D] | 1.000 - 2.500 | 6-8 | Ø8 / 15x15 | 4 Ø6 | 5-8 | 0-5 | 1,60 |
| Industrial and storage [Cat. E] | 2.500 - 5.000 | 8-12 | Ø10 / 20x20 | 4 Ø8 | 8-12 | 5-10 | 1,59 |
| > 5.000 kg/m ² | > 5.000 | To be evaluated contacting Geoplast's technical dept. | | | | | |

It is the designer's responsibility to evaluate that the soil is able to guarantee the pressures indicated and evaluated on New Elevator h200cm (formwork's height). In the presence of concentrated loads or other variables, please contact Geoplast's technical office. The values shown in this table consider complete maturation of the concrete - 28 days.

* Minimum reinforcement calculated in relation to the maximum load value referred to the identified category.

**The values shown, calculated in accordance with EN 1992-1-1, are purely indicative and are strongly influenced by the mechanical characteristics of the soil. The actual sizing must be evaluated case by case by an engineer.

5. PACKAGING AND TRANSPORT

| | | |
|---|----|---|
| Formwork Code | | EELEMAX7171 |
| Packaging dimensions | cm | 150 x 150 x H255 |
| N° Pieces - m ² pallet | - | 560 – 280 |
| Packaging type | - | Stacked and wrapped in plastic film on pallet |
| Package gross weight formwork (pallet included) | kg | 1700 |

| Foot Code | | EBASEMA7171 | EBASEMS7171 | EBASEMD7171 |
|---|----|---|------------------|------------------|
| Dimensions | mm | Ø125 | Ø160 | Ø200 |
| Packaging dimensions | cm | 100 x 120 x H250 | 100 x 120 x H250 | 100 x 120 x H250 |
| N° Pieces | - | 5000 | 5000 | 5000 |
| Packaging type | - | Stacked and wrapped in plastic film on pallet | | |
| Package gross weight formwork (pallet included) | kg | 670 | | |

| | | |
|---|----|---|
| Spacer Code | | EDISTEM7171 |
| Packaging dimensions | cm | 80 x 120 x H170 |
| N° Pieces | - | 4400 |
| Packaging type | - | Stacked and wrapped in plastic film on pallet |
| Package gross weight formwork (pallet included) | kg | 592 |

6. INSTALLATION (laying) METHOD

The Elevator Max installation is carried out by placing the formwork from right to left and from top to bottom, always keeping the arrow printed upwards. It is essential to check the correct fitting of the feet

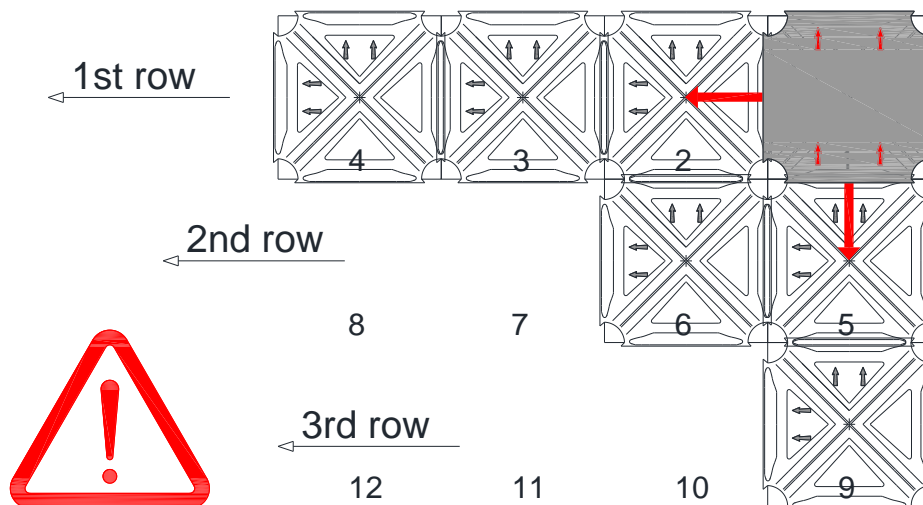

Before beginning the installation of the elements, it is recommended that you consult Geoplast's design tables in order to position the elements properly. For proper installation, in compliance with safety regulations, please refer to the installation manual.

PIPE technical data sheet

1. DESCRIPTION

PVC support structure with an external diameter of 125, 160 and 200 mm and a thickness from 1,8 to 2,8 mm.



2. TECHNICAL DATA

| | | | | |
|-------------------|----|-------------|-------------|-------------|
| Dimensions | cm | 75 > 200 | | |
| Thickness | mm | 1,8/2,0 | 2,1/2,4 | 2,5/2,8 |
| External Diameter | mm | Ø 125 | Ø 160 | Ø 200 |
| Product Code | - | EELTUBN0000 | EELTUBS0000 | EELTUBD0000 |
| Material | - | PVC | | |

STRIP technical data sheet

1. DESCRIPTION

Polystyrene strip for lateral closure of the remaining space between formwork and wall



2. TECHNICAL DATA

| | Pipe Ø125 - Ø160 | Pipe Ø200 |
|--|------------------|--------------|
| Dimensions (cm) (base x height x length) | 8 x 11 x 150 | 9 x 11 x 150 |
| Material | EPS | EPS |
| Product Code | EELLISS0150 | EELLISD0150 |